

Bullitt Assembly Manual

Designed by Larry vs Harry

For further information, check out the website : www.larryvsharry.com or your local dealer.

Before you start

Tools required for assembly:

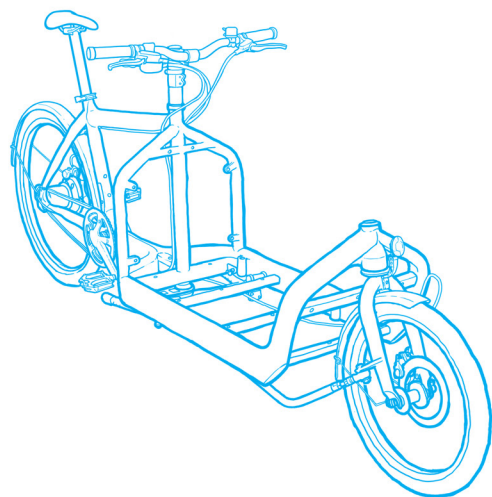

I

Allen/Hex Key

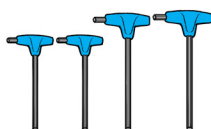

3

mm

4

mm

5

mm

6

mm

II

Screwdrivers

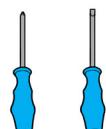

Phillips

Flathead

III

Spanners/Wrenches

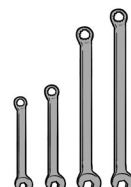

10

mm

13

mm

15

mm

19

mm

IV

Crankset tools



Hollowtech 2 bottom bracket tool (68mm bsa) and preload key

V

Pliers



VI

Stanley knife



VII

Plastic hammer



VIII



Grease sensitive parts (metal on metal)
Look out for the grease icon which will appear throughout the manual.

Grease icon:

Reference to tools and the sizes will appear on the following pages like : III 10

So if you go back to this page you know you need the Spanner/Wrench size 10 mm.

Step1

Installing the steering rod, speedlifter and headset.

Tools you need:

- I 3
- I 4

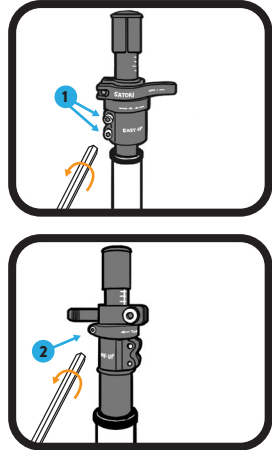
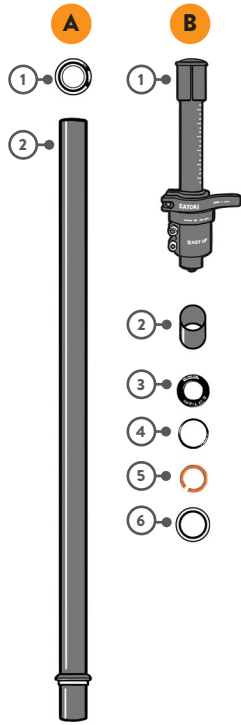
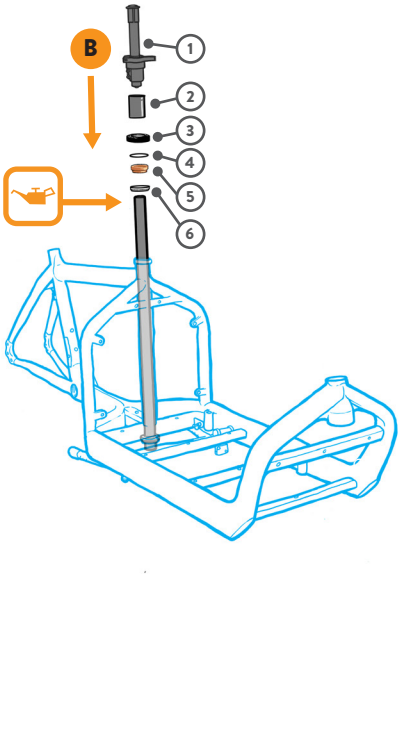

Step2

Mounting the fork and headset.

Tools you need:

- I 5
- III 19 (for removal)
- VII (for removal)

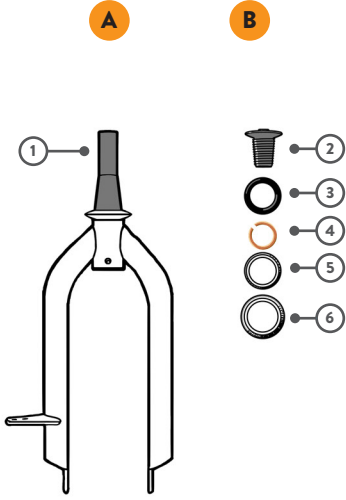
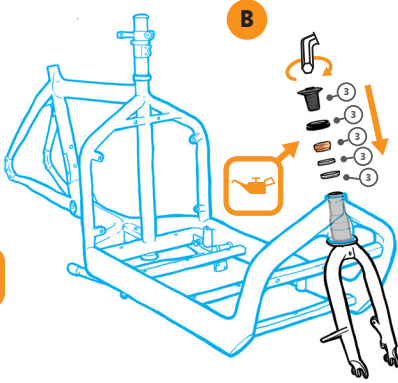
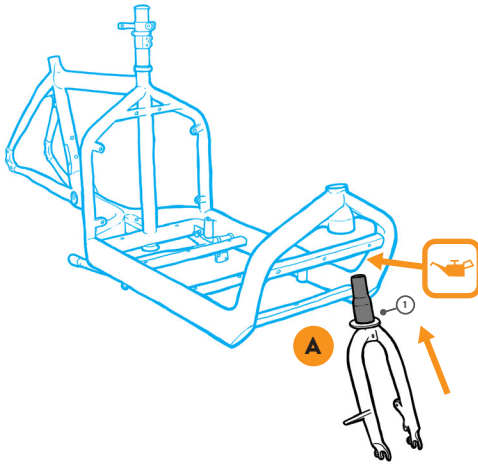

Step3

Installing the dropouts

Tools you need:

1 5

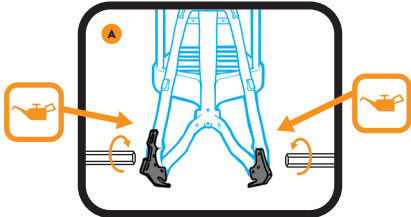
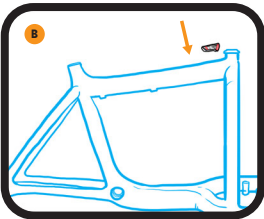
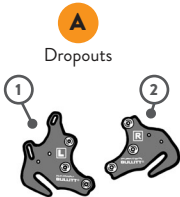

Tighten to 16.0Nm

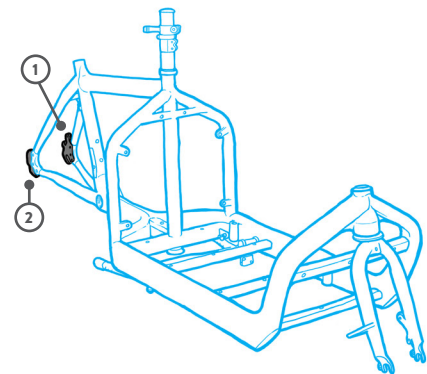

Step4

Crankset and bottom bracket installation

Tools you need:

1 5
IV

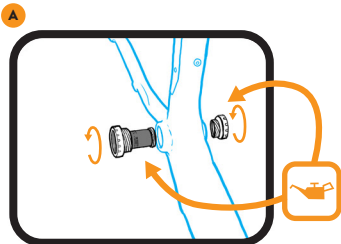
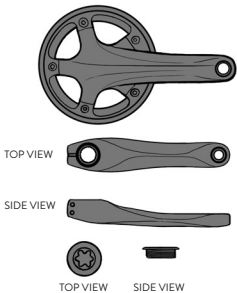
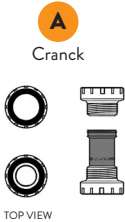

Driveside threads tighten anti-clockwise. Non-driveside tightens clockwise.
Alfine: does not need bb spacers
XT/Deore: 1 driveside/2 non driveside

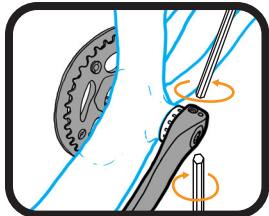
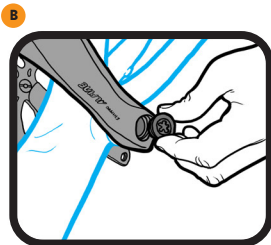

Crankset preload
Crankset bolts tighten to 14Nm

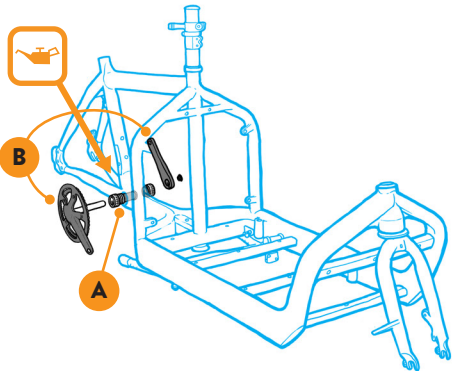

Step5

Pedal attachment

Tools you need:

- I 6
- III 15

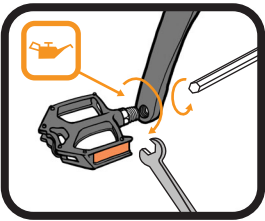
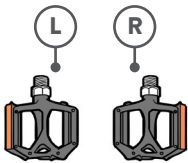

R Driveside pedal tightens clockwise.

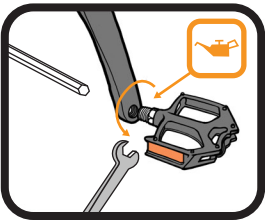

L Non-driveside pedal tightens anti clockwise.

Step6

Mounting cockpit and brake calipers.

Tools you need:

- I 4
- I 5

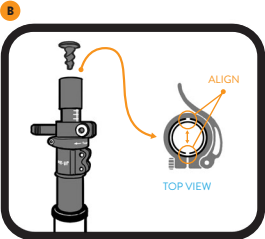
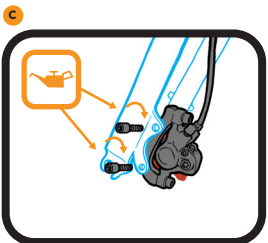
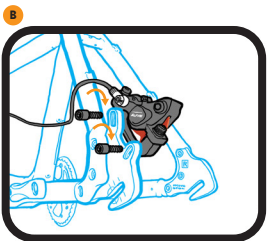
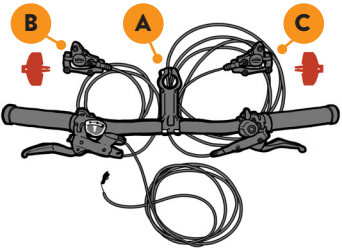
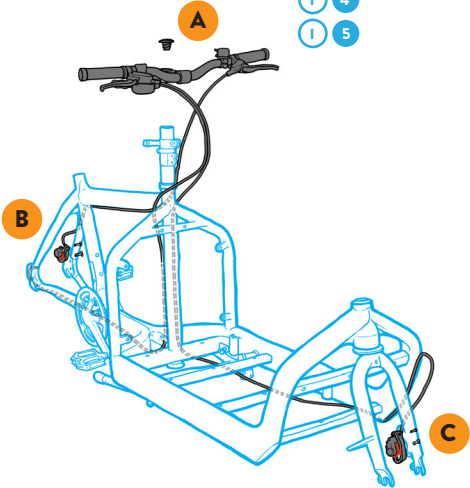

FRONT BRAKE

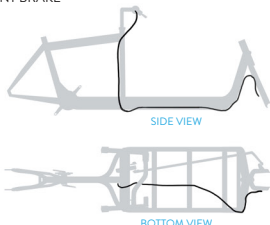

SHIFTER

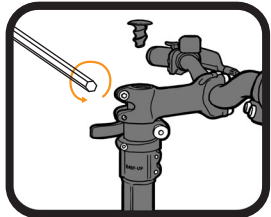
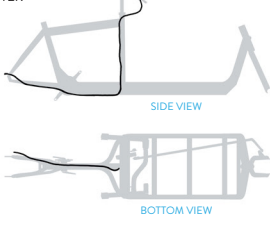

Tighten stem bolts to 6Nm.
REAR BRAKE

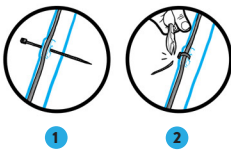

Use zip ties to attach brake cables and do not remove the red brake-pad spacers until ready for wheel installation.

Step7

Mounting mudguards and lock

Tools you need:

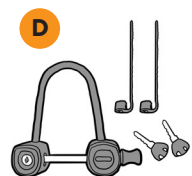
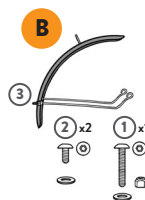
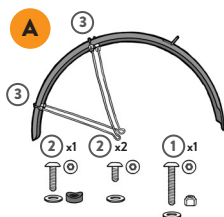
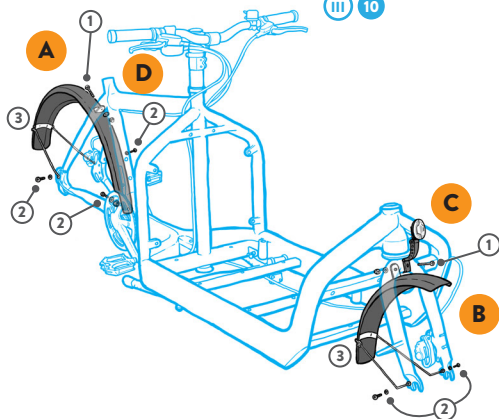

MOUNTING HARDWARE

- Tighten bolts ①
- Attach the lock ④ (see instructions) →
- Tighten bolts ②
- Adjust mudguards ③
(After you have attached the wheels)

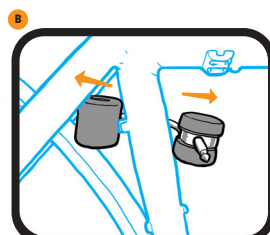

- 1 Lock should point downwards to avoid moisture entering housing.

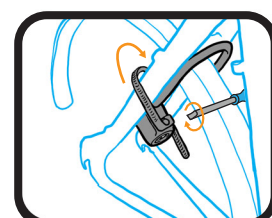

- 2 Tighten the plastic strip around both lock and seatstay, then cut away the excess.

Step8

Wheel and chain installation

Tools you need:

- III 15 Only required if mounting Nexus 7, Alfine 8 or Alfine 11.

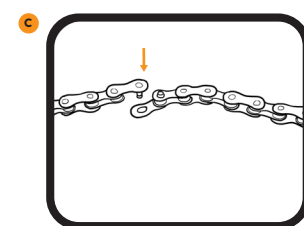
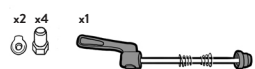
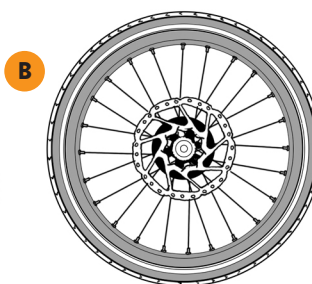
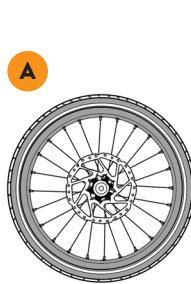
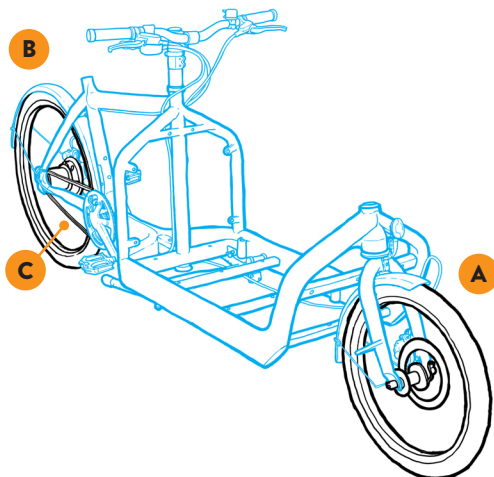

- Chains on external groups should be placed on the largest sprockets/chainrings and be given two extra links before mounting the quicklink.
- Chains on internally geared groups can simply be shortened to the correct length and mounted.

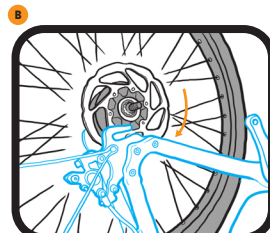
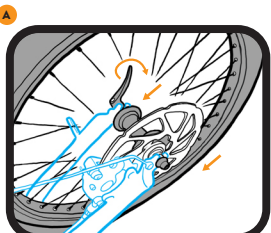

- 1 Put the wheel in fork..

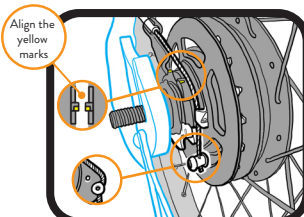

- 2 Tighten wheel nuts on Alfine to 16Nm and quick releases to a secure level.

Step9

Fitting the saddle and seatpost

Tools you need: No tools are required for this process, but remember to thoroughly grease the seat tube prior to installation.

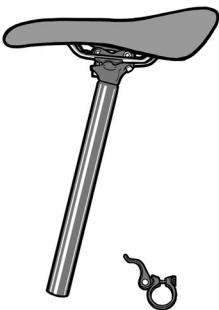
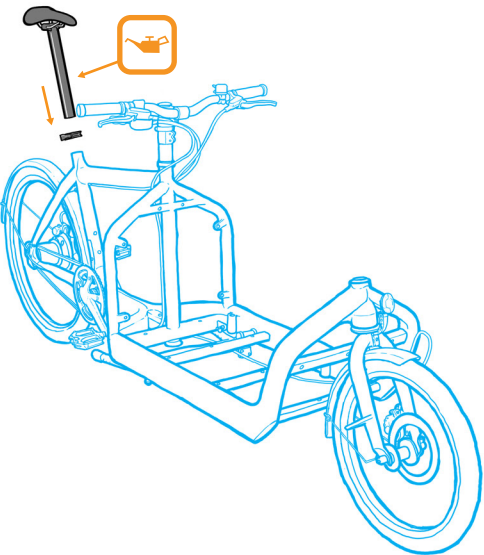

A

Saddle

B

Quick release clamp

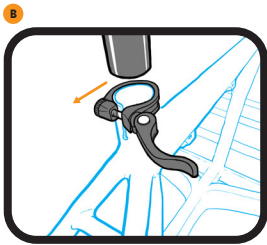

Handle goes to the right of the bike (backwards)

Step9

Attaching the steerer arm

Tools you need:

- I 5
- II 13

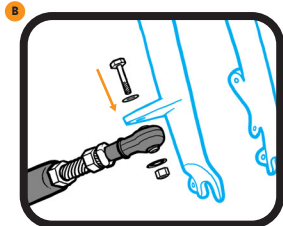
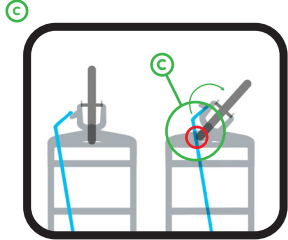
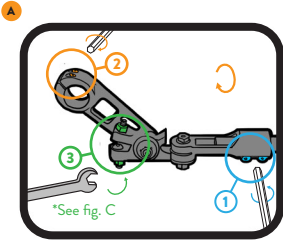
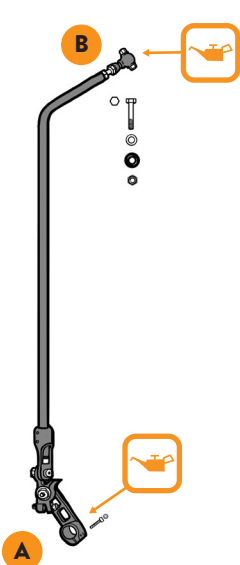
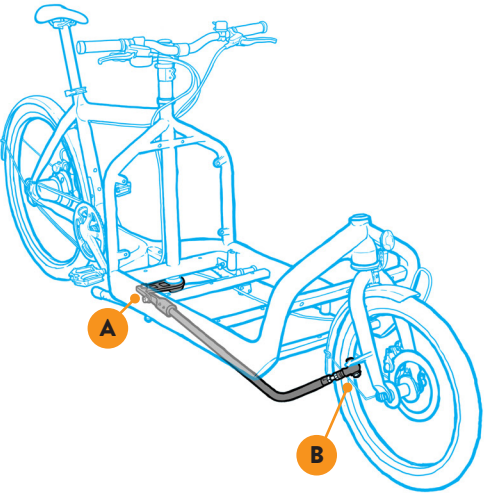

MOUNTING GUIDE

- 1 Tighten
- 2 Tighten
- 3 Adjust using the front wheel as a reference point; The wheel should not hit the steering rod when turned hard right.

Step Xtra

Incase you want to adjust gears and brakes her are some useful links on how to to that:

Shimano brake bleeding:

<https://www.youtube.com/watch?v=DsqlEYJeLQU>

Magura brake bleed video:

<https://www.youtube.com/watch?v=8wahvmtKnG4>

Rear derailleur adjustment:

<https://www.youtube.com/watch?v=Bbk5RcH0bbQ>

Front derailleur adjustment:

<https://www.youtube.com/watch?v=Ea03ChN-7Vg>
